

Air Quality Compliance Calendar for Dry Cleaning Facilities in Lane County, Oregon 2025



LRAPA
Lane Regional Air Protection Agency

LRAPA's Mission:

To protect public health, quality of life and the environment as a leader and advocate for the continuous improvement of air quality in Lane County.

Lane Regional Air Protection Agency (LRAPA)

1010 Main Street

Springfield, OR 97477

Phone: 541-736-1056 or 877-285-7272

Fax: 541-726-1205

Introduction

The State of Oregon, the Oregon Department of Environmental Quality (DEQ), and the Lane Regional Air Protection Agency (LRAPA) have developed this calendar for use by Oregon dry cleaner facilities to assist in compliance with all requirements. This calendar provides general information and tools. Please note that official and full language of all applicable LRAPA Rules and Regulations and permit conditions are the actual enforceable language. A copy of your registration should always be available on site.

[LRAPA Title 34 – Stationary Source Notification Requirements](#)

[LRAPA Title 37 – Air Contaminant Discharge Permits](#)

[LRAPA Title 37, Table 1 Section 37-8010 – Activities and Sources](#)

[LRAPA Title 37, Table 2 Section 37-8020 – Air Contaminant Discharge Permit](#)

[LRAPA Title 37, Table 3 Section 37-8030 – Cleaner Air Oregon Specific Activity Fees](#)

[LRAPA Facility Forms & Resources](#)

Lane Regional Air Protection Agency (LRAPA) and DEQ Air Quality Contacts

Air Quality Program		
Find your county	DEQ / LRAPA Staff	Phone
Clackamas, Clatsop, Columbia, Multnomah, Tillamook and Washington	Joe Contreras	503-875-0098 1-800-452-4011
Benton, Lincoln, Linn, Marion, Polk and Yamhill	Peter Susi	503-378-5408 1-800-349-7677
Lane - Lane Regional Air Protection Agency (LRAPA) www.lrapa.org	Ashley Dearden	541-736-1056, ext. 234 1-877-285-7272
Eastern Douglas, Western Douglas, Jackson, Josephine, Coos and Curry	Peter Susi	503-378-5408 1-800-349-7677
Baker, Gilliam, Grant, Malheur, Morrow, Umatilla, Union, Wallowa and Wheeler	Tom Hack	541-278-4626 1-800-304-3513
Crook, Deschutes, Gilliam, Harney, Hood River, Jefferson, Klamath, Lake Sherman, Wasco and Wheeler	Tracy Drouin	541-412-9781 1-800-452-4011

LRAPA documents can be provided upon request in an alternate format for individuals with disabilities or in a language other than English for people with limited English skills. To request a document in another format or language, call LRAPA at 541-736-1056, or toll-free at 1-877-285-7272; or email permitting@lrapa.org.

Emergency Spill Contacts	
Oregon Emergency Response System Call for Perc releases, leaks or spills more than 1 cup.	1-800-452-0311
National Response Center	1-800-424-8802

Dry Cleaning Machine Service Providers				
Arent Machinery Co.	Jay-Dee Arent	503-657-3000	arentmach@arentmachinery.com	CCB# 79174
Best Equipment Co.	Chong Kim	971-219-2255	bestchongkim@gmail.com	CCB# 100846
HD-Machinery	Chris J. Kim	503-997-5441	uml125@hanmail.net	CCB# 176823
Peterson Equip Co.	Russell Peterson	503-981-4032	russell@peterson-eq.com	CCB# 84500

The following information is from DEQ Hazardous Waste Department for your information and use along with the LRAPA Air quality information provided.

Dear Dry Cleaner,

Welcome to 2025! We hope it will be a good year for you, your family, and your business. This calendar is designed to help you comply with LRAPA and DEQ requirements, and to keep perc from impacting the health of your employees, your neighbors, and the environment. There are some common violations that LRAPA and DEQ find when inspecting perc dry cleaners. Are you making any of these mistakes? Check now to avoid hassles and fines in case you get inspected this year.

Leak Checks

Use your leak detector, do a careful check each week, and mark the results in this calendar. If you get a “beep”, investigate - is there a gasket going bad? A leaky connection? Walk outside before you turn on your leak detector, so it calibrates in clean air.

Records

Keep records on site at your place of business for 5 years, including compliance calendars, perc purchase receipts, hazardous waste disposal records, and repair records.

Hazardous Waste

Is your hazardous waste drum labeled with the accumulation start date, the first date when waste was put into that drum? Waste can be kept on site for up to 1 year. You can request an extension from DEQ for up to 1 more year, by emailing them at drycleanerinfo@deq.oregon.gov.

Secondary Containment

Hazardous waste drums and wastewater treatment units must have secondary containment that will hold 110% of the volume of the container.

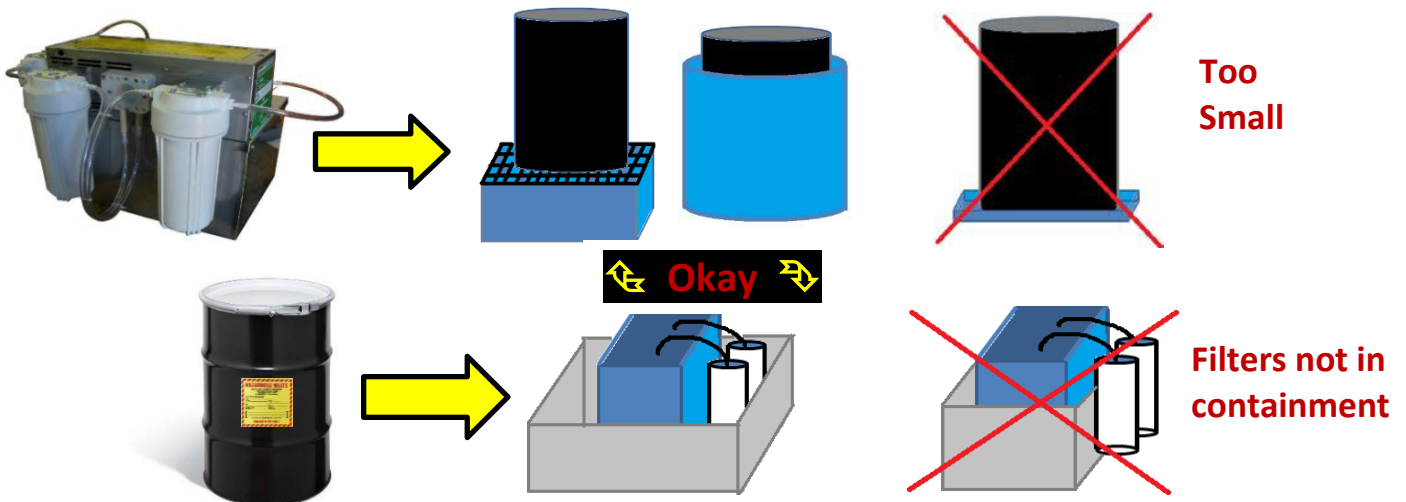

Want more details? A copy of your Air Quality permit conditions is included at the end of this calendar. Also, remember that your annual report and fee payment must be received by LRAPA on or before **March 1st, 2025**. If you have any questions, please contact us at permitting@lrapa.org or 541-736-1056.

Leak Detection					
Conduct leak inspection tests weekly on all parts of the equipment.	1. Enter date of the inspections 2. Check equipment, circle "Y" if a leak is detected, "N" if a leak is not detected.				
Enter inspection date					
Hoses	Y N	Y N	Y N	Y N	Y N
Pipe connections	Y N	Y N	Y N	Y N	Y N
Fittings, couplings, and valves	Y N	Y N	Y N	Y N	Y N
Door gasket and seating	Y N	Y N	Y N	Y N	Y N
Pump	Y N	Y N	Y N	Y N	Y N
Solvent tank and containers	Y N	Y N	Y N	Y N	Y N
Water Separator	Y N	Y N	Y N	Y N	Y N
Still/distillation	Y N	Y N	Y N	Y N	Y N
Exhaust damper	Y N	Y N	Y N	Y N	Y N
Diverter valve	Y N	Y N	Y N	Y N	Y N
Filter gasket and seating	Y N	Y N	Y N	Y N	Y N
All machine filters	Y N	Y N	Y N	Y N	Y N
Sealed waste containers (<i>wastewater, filters, lint, still bottoms</i>)	Y N	Y N	Y N	Y N	Y N
Repair leaks within 24 hours of detection. If parts are required for repair, order within two days, and complete installation within 5 days.					
Parts ordered: Enter date					
Parts received: Enter date					
Repair Complete: Enter date					

Condenser Temperature	
Enter outlet temperature weekly during cool down (should be less than 45°F or 7°C)	
Date	Outlet Temperature

Hazardous Waste		
Enter waste generated monthly		
Cartridge filters replaced		# of filters
Still bottoms generated		pounds
Lint, wastewater filters		pounds
Wastewater evaporated and/or collected in bucket		gallons
Wastewater treatment unit filter changed (<i>enter date</i>)		
Carbon Adsorbers (<i>enter dates</i> CA Desorbed)		

Waste Containers Labeled & Dated?	Y	N
Containment equipment inspected? <i>Dry cleaning machine pan seal, wastewater treatment unit, waste containers, and new solvent</i>	Y	N

PERC Purchases	
Date:	Date:
Gallons:	Gallons:

January 2025

Sunday	Monday	Tuesday	Wednesday	Thursday	Friday	Saturday
2024 Annual Report and 2025 Air Quality fees must be received by LRAPA by Monday, March 1, 2025.						
			1	2	3 <input type="checkbox"/> Temp logged <input type="checkbox"/> Inspect logged	4
5	6	7	8	9	10 <input type="checkbox"/> Temp logged <input type="checkbox"/> Inspect logged	11
12	13	14	15	16	17 <input type="checkbox"/> Temp logged <input type="checkbox"/> Inspect logged	18
19	20	21	22	23	24 <input type="checkbox"/> Temp logged <input type="checkbox"/> Inspect logged	25
26	27	28	29	30	31 <input type="checkbox"/> Temp logged <input type="checkbox"/> Inspect logged	

Leak Detection					
Conduct leak inspection tests weekly on all parts of the equipment.	1. Enter date of the inspections 2. Check equipment, circle "Y" if a leak is detected, "N" if a leak is not detected.				
Enter inspection date					
Hoses	Y N	Y N	Y N	Y N	Y N
Pipe connections	Y N	Y N	Y N	Y N	Y N
Fittings, couplings, and valves	Y N	Y N	Y N	Y N	Y N
Door gasket and seating	Y N	Y N	Y N	Y N	Y N
Pump	Y N	Y N	Y N	Y N	Y N
Solvent tank and containers	Y N	Y N	Y N	Y N	Y N
Water Separator	Y N	Y N	Y N	Y N	Y N
Still/distillation	Y N	Y N	Y N	Y N	Y N
Exhaust damper	Y N	Y N	Y N	Y N	Y N
Diverter valve	Y N	Y N	Y N	Y N	Y N
Filter gasket and seating	Y N	Y N	Y N	Y N	Y N
All machine filters	Y N	Y N	Y N	Y N	Y N
Sealed waste containers (<i>wastewater, filters, lint, still bottoms</i>)	Y N	Y N	Y N	Y N	Y N
Repair leaks within 24 hours of detection. If parts are required for repair, order within two days, and complete installation within 5 days.					
Parts ordered: Enter date					
Parts received: Enter date					
Repair Complete: Enter date					

Condenser Temperature	
Enter outlet temperature weekly during cool down (should be less than 45°F or 7°C)	
Date	Outlet Temperature

Hazardous Waste		
Enter waste generated monthly		
Cartridge filters replaced		# of filters
Still bottoms generated		pounds
Lint, wastewater filters		pounds
Wastewater evaporated and/or collected in bucket		gallons
Wastewater treatment unit filter changed (<i>enter date</i>)		
Carbon Adsorbers (<i>enter dates</i> CA Desorbed)		
Waste Containers Labeled & Dated?	Y	N
Containment equipment inspected? (<i>Dry cleaning machine pan seal, wastewater treatment unit, waste containers, and new solvent</i>)	Y	N
PERC Purchases		
Date:	Date:	
Gallons:	Gallons:	

February 2025

Sunday	Monday	Tuesday	Wednesday	Thursday	Friday	Saturday
2024 Annual Report and 2025 Air Quality fees must be received by LRAPA by Monday, March 1, 2025.						
						1
2	3	4	5	6	7	8
					<input type="checkbox"/> Temp logged <input type="checkbox"/> Inspect logged	
9	10	11	12	13	14	15
					<input type="checkbox"/> Temp logged <input type="checkbox"/> Inspect logged	
16	17	18	19	20	21	22
					<input type="checkbox"/> Temp logged <input type="checkbox"/> Inspect logged	
23	24	25	26	27	28	
					<input type="checkbox"/> Temp logged <input type="checkbox"/> Inspect logged	

Leak Detection					
Conduct leak inspection tests weekly on all parts of the equipment.	1. Enter date of the inspections 2. Check equipment, circle "Y" if a leak is detected, "N" if a leak is not detected.				
Enter inspection date					
Hoses	Y N	Y N	Y N	Y N	Y N
Pipe connections	Y N	Y N	Y N	Y N	Y N
Fittings, couplings, and valves	Y N	Y N	Y N	Y N	Y N
Door gasket and seating	Y N	Y N	Y N	Y N	Y N
Pump	Y N	Y N	Y N	Y N	Y N
Solvent tank and containers	Y N	Y N	Y N	Y N	Y N
Water Separator	Y N	Y N	Y N	Y N	Y N
Still/distillation	Y N	Y N	Y N	Y N	Y N
Exhaust damper	Y N	Y N	Y N	Y N	Y N
Diverter valve	Y N	Y N	Y N	Y N	Y N
Filter gasket and seating	Y N	Y N	Y N	Y N	Y N
All machine filters	Y N	Y N	Y N	Y N	Y N
Sealed waste containers (wastewater, filters, lint, still bottoms)	Y N	Y N	Y N	Y N	Y N
Repair leaks within 24 hours of detection. If parts are required for repair, order within two days, and complete installation within 5 days.					
Parts ordered: Enter date					
Parts received: Enter date					
Repair Complete: Enter date					

Condenser Temperature	
Enter outlet temperature weekly during cool down (should be less than 45°F or 7°C)	
Date	Outlet Temperature

Hazardous Waste		
Enter waste generated monthly		
Cartridge filters replaced		# of filters
Still bottoms generated		pounds
Lint, wastewater filters		pounds
Wastewater evaporated and/or collected in bucket		gallons
Wastewater treatment unit filter changed (enter date)		
Carbon Adsorbers (enter dates CA Desorbed)		
Waste Containers Labeled & Dated?	Y	N
Containment equipment inspected? Dry cleaning machine pan seal, wastewater treatment unit, waste containers, and new solvent	Y	N
PERC Purchases		
Date:	Date:	
Gallons:	Gallons:	

March 2025

Sunday	Monday	Tuesday	Wednesday	Thursday	Friday	Saturday
2024 Annual Report and 2025 Air Quality fees must be received by LRAPA by Monday, March 1, 2025.						
						1 DUE: <input type="checkbox"/> 2024 Annual Report <input type="checkbox"/> 2025 Fees
2	3	4	5	6	7 <input type="checkbox"/> Temp logged <input type="checkbox"/> Inspect logged	8
9	10	11	12	13	14 <input type="checkbox"/> Temp logged <input type="checkbox"/> Inspect logged	15
16	17	18	19	20	21 <input type="checkbox"/> Temp logged <input type="checkbox"/> Inspect logged	22
23	24	25	26	27	28 <input type="checkbox"/> Temp logged <input type="checkbox"/> Inspect logged	29
	30	31				

Leak Detection					
Conduct leak inspection tests weekly on all parts of the equipment.	1. Enter date of the inspections 2. Check equipment, circle "Y" if a leak is detected, "N" if a leak is not detected.				
Enter inspection date					
Hoses	Y N	Y N	Y N	Y N	Y N
Pipe connections	Y N	Y N	Y N	Y N	Y N
Fittings, couplings, and valves	Y N	Y N	Y N	Y N	Y N
Door gasket and seating	Y N	Y N	Y N	Y N	Y N
Pump	Y N	Y N	Y N	Y N	Y N
Solvent tank and containers	Y N	Y N	Y N	Y N	Y N
Water Separator	Y N	Y N	Y N	Y N	Y N
Still/distillation	Y N	Y N	Y N	Y N	Y N
Exhaust damper	Y N	Y N	Y N	Y N	Y N
Diverter valve	Y N	Y N	Y N	Y N	Y N
Filter gasket and seating	Y N	Y N	Y N	Y N	Y N
All machine filters	Y N	Y N	Y N	Y N	Y N
Sealed waste containers (<i>wastewater, filters, lint, still bottoms</i>)	Y N	Y N	Y N	Y N	Y N
Repair leaks within 24 hours of detection. If parts are required for repair, order within two days, and complete installation within 5 days.					
Parts ordered: Enter date					
Parts received: Enter date					
Repair Complete: Enter date					

Condenser Temperature	
Enter outlet temperature weekly during cool down (should be less than 45°F or 7°C)	
Date	Outlet Temperature

Hazardous Waste		
Enter waste generated monthly		
Cartridge filters replaced		# of filters
Still bottoms generated		pounds
Lint, wastewater filters		pounds
Wastewater evaporated and/or collected in bucket		gallons
Wastewater treatment unit filter changed (<i>enter date</i>)		
Carbon Adsorbers (<i>enter dates</i> CA Desorbed)		

Waste Containers Labeled & Dated?	Y	N
Containment equipment inspected? (<i>Dry cleaning machine pan seal, wastewater treatment unit, waste containers, and new solvent</i>)	Y	N

PERC Purchases	
Date:	Date:
Gallons:	Gallons:

April 2025

Sunday	Monday	Tuesday	Wednesday	Thursday	Friday	Saturday
		1	2	3	4 <input type="checkbox"/> Temp logged <input type="checkbox"/> Inspect logged	5
6	7	8	9	10	11 <input type="checkbox"/> Temp logged <input type="checkbox"/> Inspect logged	12
13	14	15	16	17	18 <input type="checkbox"/> Temp logged <input type="checkbox"/> Inspect logged	19
20	21	22	23	24	25 <input type="checkbox"/> Temp logged <input type="checkbox"/> Inspect logged	26
27	28	29	30			

Leak Detection					
Conduct leak inspection tests weekly on all parts of the equipment.	1. Enter date of the inspections 2. Check equipment, circle "Y" if a leak is detected, "N" if a leak is not detected.				
Enter inspection date					
Hoses	Y N	Y N	Y N	Y N	Y N
Pipe connections	Y N	Y N	Y N	Y N	Y N
Fittings, couplings, and valves	Y N	Y N	Y N	Y N	Y N
Door gasket and seating	Y N	Y N	Y N	Y N	Y N
Pump	Y N	Y N	Y N	Y N	Y N
Solvent tank and containers	Y N	Y N	Y N	Y N	Y N
Water Separator	Y N	Y N	Y N	Y N	Y N
Still/distillation	Y N	Y N	Y N	Y N	Y N
Exhaust damper	Y N	Y N	Y N	Y N	Y N
Diverter valve	Y N	Y N	Y N	Y N	Y N
Filter gasket and seating	Y N	Y N	Y N	Y N	Y N
All machine filters	Y N	Y N	Y N	Y N	Y N
Sealed waste containers (<i>wastewater, filters, lint, still bottoms</i>)	Y N	Y N	Y N	Y N	Y N
Repair leaks within 24 hours of detection. If parts are required for repair, order within two days, and complete installation within 5 days.					
Parts ordered: Enter date					
Parts received: Enter date					
Repair Complete: Enter date					

Condenser Temperature	
Enter outlet temperature weekly during cool down (should be less than 45°F or 7°C)	
Date	Outlet Temperature

Hazardous Waste		
Enter waste generated monthly		
Cartridge filters replaced		# of filters
Still bottoms generated		pounds
Lint, wastewater filters		pounds
Wastewater evaporated and/or collected in bucket		gallons
Wastewater treatment unit filter changed (<i>enter date</i>)		
Carbon Adsorbers (<i>enter dates</i> CA Desorbed)		
Waste Containers Labeled & Dated?	Y	N
Containment equipment inspected? (<i>Dry cleaning machine pan seal, wastewater treatment unit, waste containers, and new solvent</i>)	Y	N
PERC Purchases		
Date:	Date:	
Gallons:	Gallons:	

May 2025

Sunday	Monday	Tuesday	Wednesday	Thursday	Friday	Saturday
				1	2 <input type="checkbox"/> Temp logged <input type="checkbox"/> Inspect logged	3
4	5	6	7	8	9 <input type="checkbox"/> Temp logged <input type="checkbox"/> Inspect logged	10
11	12	13	14	15	16 <input type="checkbox"/> Temp logged <input type="checkbox"/> Inspect logged	17
18	19	20	21	22	23 <input type="checkbox"/> Temp logged <input type="checkbox"/> Inspect logged	24
25	26	27	28	29	30 <input type="checkbox"/> Temp logged <input type="checkbox"/> Inspect logged	31

Leak Detection					
Conduct leak inspection tests weekly on all parts of the equipment.	1. Enter date of the inspections 2. Check equipment, circle "Y" if a leak is detected, "N" if a leak is not detected.				
Enter inspection date					
Hoses	Y N	Y N	Y N	Y N	Y N
Pipe connections	Y N	Y N	Y N	Y N	Y N
Fittings, couplings, and valves	Y N	Y N	Y N	Y N	Y N
Door gasket and seating	Y N	Y N	Y N	Y N	Y N
Pump	Y N	Y N	Y N	Y N	Y N
Solvent tank and containers	Y N	Y N	Y N	Y N	Y N
Water Separator	Y N	Y N	Y N	Y N	Y N
Still/distillation	Y N	Y N	Y N	Y N	Y N
Exhaust damper	Y N	Y N	Y N	Y N	Y N
Diverter valve	Y N	Y N	Y N	Y N	Y N
Filter gasket and seating	Y N	Y N	Y N	Y N	Y N
All machine filters	Y N	Y N	Y N	Y N	Y N
Sealed waste containers (<i>wastewater, filters, lint, still bottoms</i>)	Y N	Y N	Y N	Y N	Y N
Repair leaks within 24 hours of detection. If parts are required for repair, order within two days, and complete installation within 5 days.					
Parts ordered: Enter date					
Parts received: Enter date					
Repair Complete: Enter date					

Condenser Temperature	
Enter outlet temperature weekly during cool down (should be less than 45°F or 7°C)	
Date	Outlet Temperature

Hazardous Waste		
Enter waste generated monthly		
Cartridge filters replaced		# of filters
Still bottoms generated		pounds
Lint, wastewater filters		pounds
Wastewater evaporated and/or collected in bucket		gallons
Wastewater treatment unit filter changed (<i>enter date</i>)		
Carbon Adsorbers (<i>enter dates</i> CA Desorbed)		

Waste Containers Labeled & Dated?	Y	N
Containment equipment inspected? <i>Dry cleaning machine pan seal, wastewater treatment unit, waste containers, and new solvent</i>	Y	N

PERC Purchases	
Date:	Date:
Gallons:	Gallons:

June 2025

Sunday	Monday	Tuesday	Wednesday	Thursday	Friday	Saturday
1	2	3	4	5	6 <input type="checkbox"/> Temp logged <input type="checkbox"/> Inspect logged	7
8	9	10	11	12	13 <input type="checkbox"/> Temp logged <input type="checkbox"/> Inspect logged	14
15	16	17	18	19	20 <input type="checkbox"/> Temp logged <input type="checkbox"/> Inspect logged	21
22	23	24	25	26	27 <input type="checkbox"/> Temp logged <input type="checkbox"/> Inspect logged	28
29	30					

Leak Detection					
Conduct leak inspection tests weekly on all parts of the equipment.	1. Enter date of the inspections 2. Check equipment, circle "Y" if a leak is detected, "N" if a leak is not detected.				
Enter inspection date					
Hoses	Y N	Y N	Y N	Y N	Y N
Pipe connections	Y N	Y N	Y N	Y N	Y N
Fittings, couplings, and valves	Y N	Y N	Y N	Y N	Y N
Door gasket and seating	Y N	Y N	Y N	Y N	Y N
Pump	Y N	Y N	Y N	Y N	Y N
Solvent tank and containers	Y N	Y N	Y N	Y N	Y N
Water Separator	Y N	Y N	Y N	Y N	Y N
Still/distillation	Y N	Y N	Y N	Y N	Y N
Exhaust damper	Y N	Y N	Y N	Y N	Y N
Diverter valve	Y N	Y N	Y N	Y N	Y N
Filter gasket and seating	Y N	Y N	Y N	Y N	Y N
All machine filters	Y N	Y N	Y N	Y N	Y N
Sealed waste containers (<i>wastewater, filters, lint, still bottoms</i>)	Y N	Y N	Y N	Y N	Y N
Repair leaks within 24 hours of detection. If parts are required for repair, order within two days, and complete installation within 5 days.					
Parts ordered: Enter date					
Parts received: Enter date					
Repair Complete: Enter date					

Condenser Temperature	
Enter outlet temperature weekly during cool down (should be less than 45°F or 7°C)	
Date	Outlet Temperature

Hazardous Waste		
Enter waste generated monthly		
Cartridge filters replaced		# of filters
Still bottoms generated		pounds
Lint, wastewater filters		pounds
Wastewater evaporated and/or collected in bucket		gallons
Wastewater treatment unit filter changed (<i>enter date</i>)		
Carbon Adsorbers (<i>enter dates</i> CA Desorbed)		

Waste Containers Labeled & Dated?	Y N
Containment equipment inspected? <i>Dry cleaning machine pan seal, wastewater treatment unit, waste containers, and new solvent</i>	Y N

PERC Purchases	
Date:	Date:
Gallons:	Gallons:

July 2025

Sunday	Monday	Tuesday	Wednesday	Thursday	Friday	Saturday
		1	2	3	4 <input type="checkbox"/> Temp logged <input type="checkbox"/> Inspect logged	5
6	7	8	9	10	11 <input type="checkbox"/> Temp logged <input type="checkbox"/> Inspect logged	12
13	14	15	16	17	18 <input type="checkbox"/> Temp logged <input type="checkbox"/> Inspect logged	19
20	21	22	23	24	25 <input type="checkbox"/> Temp logged <input type="checkbox"/> Inspect logged	26
27	28	29	30	31		

Leak Detection					
Conduct leak inspection tests weekly on all parts of the equipment.	1. Enter date of the inspections 2. Check equipment, circle "Y" if a leak is detected, "N" if a leak is not detected.				
Enter inspection date					
Hoses	Y N	Y N	Y N	Y N	Y N
Pipe connections	Y N	Y N	Y N	Y N	Y N
Fittings, couplings, and valves	Y N	Y N	Y N	Y N	Y N
Door gasket and seating	Y N	Y N	Y N	Y N	Y N
Pump	Y N	Y N	Y N	Y N	Y N
Solvent tank and containers	Y N	Y N	Y N	Y N	Y N
Water Separator	Y N	Y N	Y N	Y N	Y N
Still/distillation	Y N	Y N	Y N	Y N	Y N
Exhaust damper	Y N	Y N	Y N	Y N	Y N
Diverter valve	Y N	Y N	Y N	Y N	Y N
Filter gasket and seating	Y N	Y N	Y N	Y N	Y N
All machine filters	Y N	Y N	Y N	Y N	Y N
Sealed waste containers (<i>wastewater, filters, lint, still bottoms</i>)	Y N	Y N	Y N	Y N	Y N
Repair leaks within 24 hours of detection. If parts are required for repair, order within two days, and complete installation within 5 days.					
Parts ordered: Enter date					
Parts received: Enter date					
Repair Complete: Enter date					

Condenser Temperature	
Enter outlet temperature weekly during cool down (should be less than 45°F or 7°C)	
Date	Outlet Temperature

Hazardous Waste		
Enter waste generated monthly		
Cartridge filters replaced		# of filters
Still bottoms generated		pounds
Lint, wastewater filters		pounds
Wastewater evaporated and/or collected in bucket		gallons
Wastewater treatment unit filter changed (<i>enter date</i>)		
Carbon Adsorbers (<i>enter dates</i> CA Desorbed)		
Waste Containers Labeled & Dated?	Y	N
Containment equipment inspected? (<i>Dry cleaning machine pan seal, wastewater treatment unit, waste containers, and new solvent</i>)	Y	N
PERC Purchases		
Date:	Date:	
Gallons:	Gallons:	

August 2025

Sunday	Monday	Tuesday	Wednesday	Thursday	Friday	Saturday
					1 <input type="checkbox"/> Temp logged <input type="checkbox"/> Inspect logged	2
3	4	5	6	7	8 <input type="checkbox"/> Temp logged <input type="checkbox"/> Inspect logged	9
10	11	12	13	14	15 <input type="checkbox"/> Temp logged <input type="checkbox"/> Inspect logged	16
17	18	19	20	21	22 <input type="checkbox"/> Temp logged <input type="checkbox"/> Inspect logged	23
24 31	25	26	27	28	29 <input type="checkbox"/> Temp logged <input type="checkbox"/> Inspect logged	30

Leak Detection					
Conduct leak inspection tests weekly on all parts of the equipment.	1. Enter date of the inspections 2. Check equipment, circle "Y" if a leak is detected, "N" if a leak is not detected.				
Enter inspection date					
Hoses	Y N	Y N	Y N	Y N	Y N
Pipe connections	Y N	Y N	Y N	Y N	Y N
Fittings, couplings, and valves	Y N	Y N	Y N	Y N	Y N
Door gasket and seating	Y N	Y N	Y N	Y N	Y N
Pump	Y N	Y N	Y N	Y N	Y N
Solvent tank and containers	Y N	Y N	Y N	Y N	Y N
Water Separator	Y N	Y N	Y N	Y N	Y N
Still/distillation	Y N	Y N	Y N	Y N	Y N
Exhaust damper	Y N	Y N	Y N	Y N	Y N
Diverter valve	Y N	Y N	Y N	Y N	Y N
Filter gasket and seating	Y N	Y N	Y N	Y N	Y N
All machine filters	Y N	Y N	Y N	Y N	Y N
Sealed waste containers (<i>wastewater, filters, lint, still bottoms</i>)	Y N	Y N	Y N	Y N	Y N
Repair leaks within 24 hours of detection. If parts are required for repair, order within two days, and complete installation within 5 days.					
Parts ordered: Enter date					
Parts received: Enter date					
Repair Complete: Enter date					

Condenser Temperature	
Enter outlet temperature weekly during cool down (should be less than 45°F or 7°C)	
Date	Outlet Temperature

Hazardous Waste		
Enter waste generated monthly		
Cartridge filters replaced		# of filters
Still bottoms generated		pounds
Lint, wastewater filters		pounds
Wastewater evaporated and/or collected in bucket		gallons
Wastewater treatment unit filter changed (<i>enter date</i>)		
Carbon Adsorbers (<i>enter dates</i> CA Desorbed)		

Waste Containers Labeled & Dated?	Y	N
Containment equipment inspected? (<i>Dry cleaning machine pan seal, wastewater treatment unit, waste containers, and new solvent</i>)	Y	N

PERC Purchases	
Date:	Date:
Gallons:	Gallons:

September 2025

Sunday	Monday	Tuesday	Wednesday	Thursday	Friday	Saturday
	1	2	3	4	5 <input type="checkbox"/> Temp logged <input type="checkbox"/> Inspect logged	6
7	8	9	10	11	12 <input type="checkbox"/> Temp logged <input type="checkbox"/> Inspect logged	13
14	15	16	17	18	19 <input type="checkbox"/> Temp logged <input type="checkbox"/> Inspect logged	20
21	22	23	24	25	26 <input type="checkbox"/> Temp logged <input type="checkbox"/> Inspect logged	27
28	29	30				

Leak Detection					
Conduct leak inspection tests weekly on all parts of the equipment.	1. Enter date of the inspections 2. Check equipment, circle "Y" if a leak is detected, "N" if a leak is not detected.				
Enter inspection date					
Hoses	Y N	Y N	Y N	Y N	Y N
Pipe connections	Y N	Y N	Y N	Y N	Y N
Fittings, couplings, and valves	Y N	Y N	Y N	Y N	Y N
Door gasket and seating	Y N	Y N	Y N	Y N	Y N
Pump	Y N	Y N	Y N	Y N	Y N
Solvent tank and containers	Y N	Y N	Y N	Y N	Y N
Water Separator	Y N	Y N	Y N	Y N	Y N
Still/distillation	Y N	Y N	Y N	Y N	Y N
Exhaust damper	Y N	Y N	Y N	Y N	Y N
Diverter valve	Y N	Y N	Y N	Y N	Y N
Filter gasket and seating	Y N	Y N	Y N	Y N	Y N
All machine filters	Y N	Y N	Y N	Y N	Y N
Sealed waste containers (<i>wastewater, filters, lint, still bottoms</i>)	Y N	Y N	Y N	Y N	Y N
Repair leaks within 24 hours of detection. If parts are required for repair, order within two days, and complete installation within 5 days.					
Parts ordered: Enter date					
Parts received: Enter date					
Repair Complete: Enter date					

Condenser Temperature	
Enter outlet temperature weekly during cool down (should be less than 45°F or 7°C)	
Date	Outlet Temperature

Hazardous Waste		
Enter waste generated monthly		
Cartridge filters replaced		# of filters
Still bottoms generated		pounds
Lint, wastewater filters		pounds
Wastewater evaporated and/or collected in bucket		gallons
Wastewater treatment unit filter changed (<i>enter date</i>)		
Carbon Adsorbers (<i>enter dates</i> CA Desorbed)		
Waste Containers Labeled & Dated?		Y N
Containment equipment inspected? <i>Dry cleaning machine pan seal, wastewater treatment unit, waste containers, and new solvent</i>		Y N
PERC Purchases		
Date:	Date:	
Gallons:	Gallons:	

October 2025

Sunday	Monday	Tuesday	Wednesday	Thursday	Friday	Saturday
1	2	3	4	5	6 <input type="checkbox"/> Temp logged <input type="checkbox"/> Inspect logged	7
8	9	10	11	12	13 <input type="checkbox"/> Temp logged <input type="checkbox"/> Inspect logged	14
15	16	17	18	19	20 <input type="checkbox"/> Temp logged <input type="checkbox"/> Inspect logged	21
22	23	24	25	26	27 <input type="checkbox"/> Temp logged <input type="checkbox"/> Inspect logged	28
29	30	31				

Leak Detection					
Conduct leak inspection tests weekly on all parts of the equipment.	1. Enter date of the inspections 2. Check equipment, circle "Y" if a leak is detected, "N" if a leak is not detected.				
Enter inspection date					
Hoses	Y N	Y N	Y N	Y N	Y N
Pipe connections	Y N	Y N	Y N	Y N	Y N
Fittings, couplings, and valves	Y N	Y N	Y N	Y N	Y N
Door gasket and seating	Y N	Y N	Y N	Y N	Y N
Pump	Y N	Y N	Y N	Y N	Y N
Solvent tank and containers	Y N	Y N	Y N	Y N	Y N
Water Separator	Y N	Y N	Y N	Y N	Y N
Still/distillation	Y N	Y N	Y N	Y N	Y N
Exhaust damper	Y N	Y N	Y N	Y N	Y N
Diverter valve	Y N	Y N	Y N	Y N	Y N
Filter gasket and seating	Y N	Y N	Y N	Y N	Y N
All machine filters	Y N	Y N	Y N	Y N	Y N
Sealed waste containers (<i>wastewater, filters, lint, still bottoms</i>)	Y N	Y N	Y N	Y N	Y N
Repair leaks within 24 hours of detection. If parts are required for repair, order within two days, and complete installation within 5 days.					
Parts ordered: Enter date					
Parts received: Enter date					
Repair Complete: Enter date					

Condenser Temperature	
Enter outlet temperature weekly during cool down (should be less than 45°F or 7°C)	
Date	Outlet Temperature

Hazardous Waste		
Enter waste generated monthly		
Cartridge filters replaced		# of filters
Still bottoms generated		pounds
Lint, wastewater filters		pounds
Wastewater evaporated and/or collected in bucket		gallons
Wastewater treatment unit filter changed (<i>enter date</i>)		
Carbon Adsorbers (<i>enter dates</i> CA Desorbed)		

Waste Containers Labeled & Dated?	Y N
Containment equipment inspected? (<i>Dry cleaning machine pan seal, wastewater treatment unit, waste containers, and new solvent</i>)	Y N

PERC Purchases	
Date:	Date:
Gallons:	Gallons:

November 2025

Sunday	Monday	Tuesday	Wednesday	Thursday	Friday	Saturday
						1
2	3	4	5	6	7 <input type="checkbox"/> Temp logged <input type="checkbox"/> Inspect logged	8
9	10	11	12	13	14 <input type="checkbox"/> Temp logged <input type="checkbox"/> Inspect logged	15
16	17	18	19	20	21 <input type="checkbox"/> Temp logged <input type="checkbox"/> Inspect logged	22
23 30	24	25	26	27	28 <input type="checkbox"/> Temp logged <input type="checkbox"/> Inspect logged	29

Leak Detection					
Conduct leak inspection tests weekly on all parts of the equipment.	1. Enter date of the inspections 2. Check equipment, circle "Y" if a leak is detected, "N" if a leak is not detected.				
Enter inspection date					
Hoses	Y N	Y N	Y N	Y N	Y N
Pipe connections	Y N	Y N	Y N	Y N	Y N
Fittings, couplings, and valves	Y N	Y N	Y N	Y N	Y N
Door gasket and seating	Y N	Y N	Y N	Y N	Y N
Pump	Y N	Y N	Y N	Y N	Y N
Solvent tank and containers	Y N	Y N	Y N	Y N	Y N
Water Separator	Y N	Y N	Y N	Y N	Y N
Still/distillation	Y N	Y N	Y N	Y N	Y N
Exhaust damper	Y N	Y N	Y N	Y N	Y N
Diverter valve	Y N	Y N	Y N	Y N	Y N
Filter gasket and seating	Y N	Y N	Y N	Y N	Y N
All machine filters	Y N	Y N	Y N	Y N	Y N
Sealed waste containers (<i>wastewater, filters, lint, still bottoms</i>)	Y N	Y N	Y N	Y N	Y N
Repair leaks within 24 hours of detection. If parts are required for repair, order within two days, and complete installation within 5 days.					
Parts ordered: Enter date					
Parts received: Enter date					
Repair Complete: Enter date					

Condenser Temperature	
Enter outlet temperature weekly during cool down (should be less than 45°F or 7°C)	
Date	Outlet Temperature

Hazardous Waste		
Enter waste generated monthly		
Cartridge filters replaced		# of filters
Still bottoms generated		pounds
Lint, wastewater filters		pounds
Wastewater evaporated and/or collected in bucket		gallons
Wastewater treatment unit filter changed (<i>enter date</i>)		
Carbon Adsorbers (<i>enter dates</i> CA Desorbed)		

Waste Containers Labeled & Dated?	Y N
Containment equipment inspected? (<i>Dry cleaning machine pan seal, wastewater treatment unit, waste containers, and new solvent</i>)	Y N

PERC Purchases	
Date:	Date:
Gallons:	Gallons:

December 2025

Sunday	Monday	Tuesday	Wednesday	Thursday	Friday	Saturday
	1	2	3	4	5 <input type="checkbox"/> Temp logged <input type="checkbox"/> Inspect logged	6
7	8	9	10	11	12 <input type="checkbox"/> Temp logged <input type="checkbox"/> Inspect logged	13
14	15	16	17	18	19 <input type="checkbox"/> Temp logged <input type="checkbox"/> Inspect logged	20
21	22	23	24	25	26 <input type="checkbox"/> Temp logged <input type="checkbox"/> Inspect logged	27
28	29	30	31			

